

AUTOMATIC Pencil Sharpener

OPERATION MANUAL

EG-5146



Thank you for purchasing the pencil sharpener.
For smooth operation and safety reasons,
And enjoy your pencil sharpener!
please read the instructions carefully and comply with
it for usage.

HOW TO USE

- Guide the pencil into the top opening gently but firmly.
 - **Do not** put too much pressure. Motor will start automaticity
 - Sharpens standard wooden, composite and recycled pencils
 - Insert a pencil into the sharpener only if the unit is positioned on a table or a stable and rigid support.
Remove sharpened pencil after 3-4 seconds.
A continued and prolonged use can damage the motor.
 - If the sharpener slows down significantly or stops while sharpening, try applying less pressure on the pencil.
 - **Do not** force or shove pencil into sharpener, as too much pressure may cause the motor to jam. If it happens simply reduce pressure until motor operates normally again.
 - Empty the receptacle when it is half full. The pencil sharpener will not operate properly when full.
- (• NOTE: make sure the receptacle is in place and tightly closed before operating your sharpener. Will not operate if receptacle is removed.)

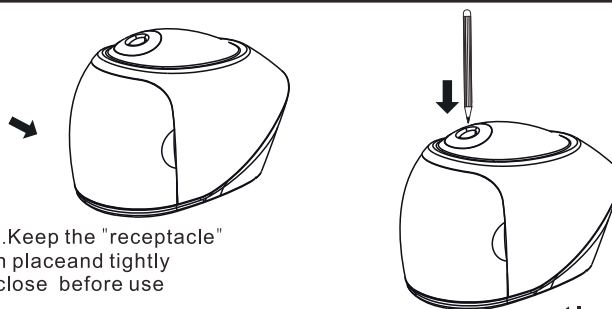

1. Keep the "receptacle" in place and tightly close before use

TROUBLE SHOOTING :

2. Push the pencil **gently**
Motor starts automatically for actions

HOW TO REMOVE BROKEN LEAD

1. Remove the receptacle and empty it.

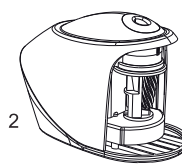
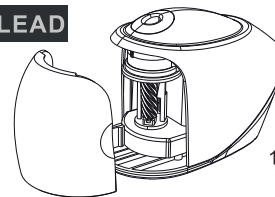

2. Hold the Sharpener up downward. Use the broken-end pencil and points it to the helical blade inside. Move the blade slightly back and forth in such way that the broken lead is released through the gap (caution : don't use metal rod or screw driver, otherwise the blade damaged).

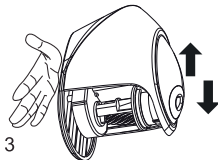

3. Face the Sharpener downward, clap & swing the device body till the broken lead can fall out through the channel.

page 1

MAINTENANCE & SAFETY INSTRUCTIONS

- To ensure smooth and trouble free sharpening:
- Always unplug the sharpener before cleaning or emptying the receptacle.
 - DO NOT sharpen writing instrument such as crayons, chalk or soft waxy pencils as they will clog your sharpener's cutter.
 - Clean the unit with a damp cloth. Do not use grease, oil or abrasive cleaners as alcohol, benzene or thinner.
 - Never submerge your sharpener in water, plugged or unplugged.
 - Never pull on the cord to turn the sharpener off. Instead, take hold of the plug and pull it slowly out of the outlet.
 - DO NOT insert fingers into the cutting hole.
 - DO NOT touch or attempt to remove cutter blades at any time to avoid injury.
 - DO NOT attempt to sharpen pencils while the receptacle cover is open.
 - DO NOT drop the unit.
 - If the receptacle breaks, dispose of the entire unit.
 - As with all electrical appliances, keep out of the reach of small children.

HOW TO INSTALL BATTERIS

Replace batteries

- Remove the lid of the battery compartment at the bottom of the sharpener.
- Insert four «AA» size new batteries in the battery compartment with correct polarity (see indications on battery compartment).
- Close battery compartment.
- Do not mix old and new batteries.
- Do always replace all four batteries at the same time.
- Do not mix alkaline, standard (carbon-zinc), or rechargeable (nickel cadmium) batteries.
- To avoid damage from battery leakage, remove batteries when unit is not used for long periods.

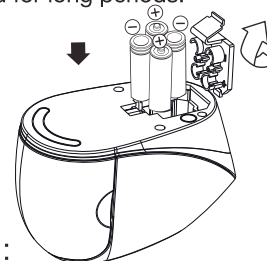

SPECIFICATION :

Power Source DC	4 AA 1.5V Dry Batteries (not included)
Dimension (WxDxH)	71 x 130 x 90 mm
Weight	212g
Pencil size(mm)	6.5<diаметer<8
Ambient temperature	-18☐ to 49☐



WARNING:
IMPORTANT SAFETY GUARDS TO AVOID SERIOUS INJURY

◆ CONSULT INSTRUCTION FOR USE

This symbol demonstrates that symbols are meant to support.
Not replace, operating instructions.



Do not dispose of electrical appliances as unsorted municipal waste, use separate collection facilities.

Contact your local government for information regarding the collection systems available. If electrical appliances are disposed of in landfills or dumps, hazardous substances can leak into the groundwater and get into the food chain, damaging your health and well-being. When replacing old appliances with new ones, the retailer is legally obligated to take back your old appliance for disposal at least for free of charge.

